

THERMOWASHER

WASHER TO FASTEN INSULATION TO WOOD

STRONG AND EFFICIENT

The THERMOWASHER is intended for use with structural self-tapping screws. To be used with HBS screws, Ø6 (Ø0.24") and Ø8 (Ø0.32"), length depending on thickness of the insulation to be fastened. Ideal for any type of insulation.

THERMAL BREAK

Incorporated hole cover to avoid thermal bridges. Large extrusions on the washer head provide for enhanced plaster adhesion.

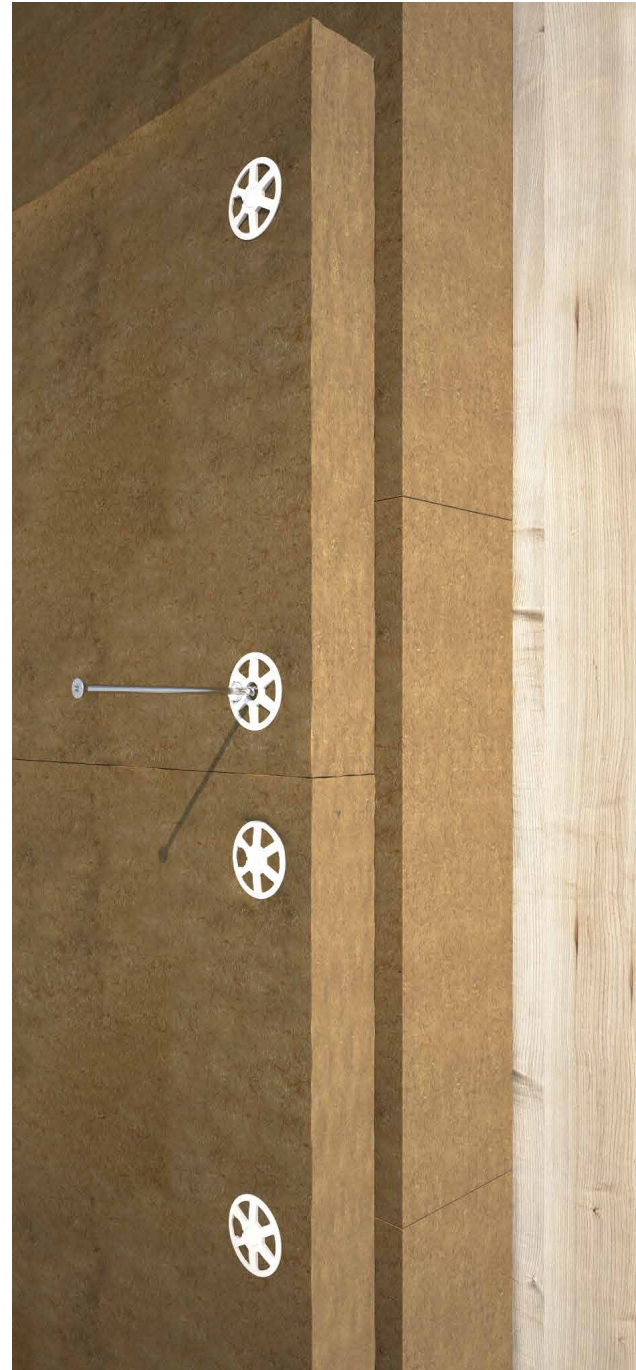

CODES AND DIMENSIONS

CODE	d _{SCREW}		a x b x c		pcs
	[mm]	[in]	[mm]	[in]	
THERMO65	6 8	0.24 0.32	65 x 4 x 20	2 9/16 x 0.16 x 0.79	700



MATERIAL

Propylene (PP).

FIELDS OF USE

The Ø65 (Ø2 9/16") propylene washer is compatible with Ø6 and Ø8 (Ø0.24" and Ø0.32") HBS screws; it is suitable for any type of insulation and any insulation thickness.