

# Meltell® 300

reliable high-performance sealant

SIGA  
1966

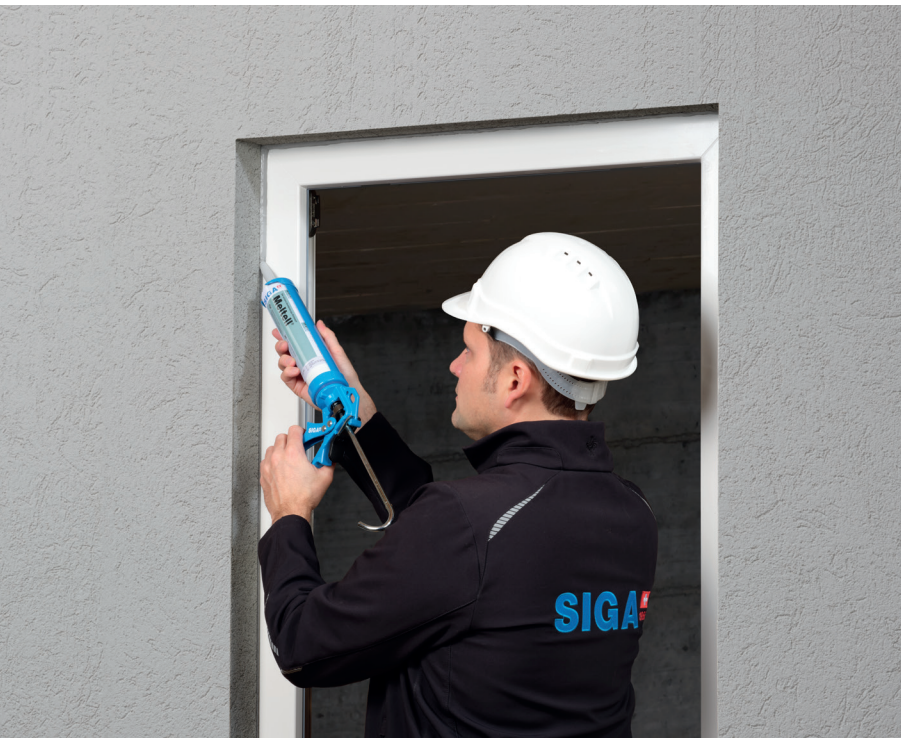

## High-performance, single-component, fast-curing hybrid sealant

Meltell 300 is a single component elastomeric adhesive sealant curing without isocyanates, used for seam and joint sealing on windows, doors and penetrations for interior and exterior applications. This hybrid technology is paintable and is ideal for bonding on different materials such as concrete, wood, aluminum, and polyester.

### CHARACTERISTICS

Packaging	Cartridge - 10.48 fl. oz (310 mL) Sausage pack - 20.28 fl. oz (600 mL)
Product color	White, Black
Movement capability	± 25%
Application temperature range	14° F to +104° F / -10° C to + 40° C

- ✓ easy to shape
- ✓ compatible with all SIGA products
- ✓ fast drying time

**SEALANT - WATERPROOFING & RESTORATION INSTITUTE**

Issued to: **SIGA COVER Inc.**  
Product: **SIGA - Meltell 300 Series**

C719: Pass  Ext:+25% Comp:-25%

**Substrate:** Unprimed Mortar, Anodized Aluminum, Vinyl and Wood

**Validation Date:** 1/19/21 - 1/18/26

No. **SIGA-011821** copyright © 2021

**SEALANT VALIDATION**  
[www.swrionline.org](http://www.swrionline.org)

# INSTALLATION INSTRUCTIONS



- Cut sealant nozzle at a 45 degree angle to approximate joint width



- Apply Meltell generously on sealant backer support in window connection joint



- Remove / smooth out excess sealant with caulking tool

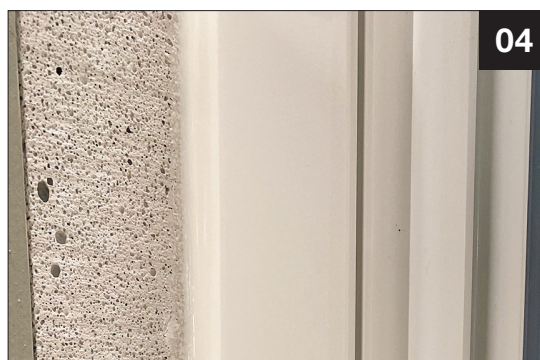

- How it should look

## 2-flank adhesion

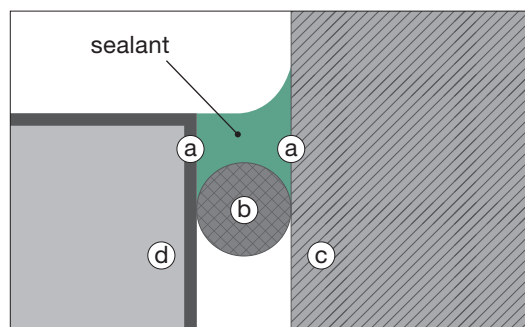

- Ⓐ flank 1 and flank 2
- Ⓑ sealant backer support
- Ⓒ building structure
- Ⓓ window frame

## Joint geometry

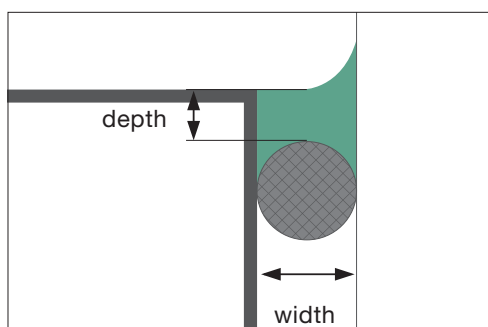

Joint WIDTH (inches)	Joint DEPTH (inches)
1/4"	1/4"
5/16"	5/16"
1/2"	1/2"
5/8"	5/16"
3/4"	3/8"
1"	1/2"
1-1/2"	3/4"

### rule of thumb:

- joint width 1/4"–1/2"      width : depth = 1 : 1
- joint width > 1/2"      width : depth = 2 : 1 / 3 : 1
- ideal joint width      1/2"–1-1/2"

All SIGA products are backed by a 10-Year Limited Warranty. Refer to [siga.swiss](http://siga.swiss) for complete details. We want you to maximize SIGA's performance potential on your project. Contact one of our Application Advisors for support, from architectural detail review to jobsite training for installers.